

EJECT X



WHEN SAFETY
MATTERS

CHANGING THE WAY MATERIAL IS MOVED

THE EJECTX BODY completely changes the way material is moved on site. Our designs both incorporate a purpose built, double bushed horizontal, hydraulic ram that pushes a plough through the Bisalloy body, ejecting any material you put in the back. These bodies will push anything from asphalt, demolition materials, rock and rubble, including hot or cold material.

The tailgate automatically lifts, then the plough moves through the bodies at either a set speed, or inched through the body for part load ejection, which allows the material to flow freely out of the body. This reduces any wear and tear on the tailgate.

We have designed and built the EjectX bodies to be safe and user friendly, to reduce the risk of damage to your equipment, and to also increase safety on site. This is possible by including safety features such as, a system where the plough cannot be moved unless the tailgate is released. You also do not have the challenges that go along with a conventional tipper.

With the EjectX, you are able to place the material you need without any stress as the EjectX easily and efficiently deposits its payload right where you need it, and exactly how you want it, everytime!



BUILT TUFF

THE PLOUGH is a laser cut, 80 grade steel design with a 450 grade skin which is trimmed with a high temperature, heavy-duty custom made temperature rated polymer scraper that is fitted to the base and sides of the plough. The scrapers are also fitted on the back side of the plough, so that if any excess material flows towards the headboard then it will be wiped clean through the outlets in the body. We have designed the EjectX bodies to have reliefs in the floor close to the headboard with bolt-on alloy guards so that no material can reside in the body after a load has been ejected. The floor is wiped clean both in its outward and inward stroke.

All of our EjectX bodies have engineer designed stabilising ribs, which run along the external of the body as they are an integral part of the design for longevity in your EjectX.

In our design, the clearance lights are recessed into the combing rail of the body for protection.



WHY WAS EACH BODY DESIGNED?

ORIGINAL EJECTX

The EjectX was designed due to a need for a safer alternative to tipping bodies, while increasing productivity. The EjectX is a heavy-duty, **GENERAL PURPOSE** body that is built for any and all material.

ASPHALT EJECTX

The Asphalt EjectX is **ASPHALT SPECIFIC**, designed to meet the needs of asphalt haulage contractors. It is a light weight body that increases the payload while keeping all of the safety aspects of our Original EjectX.

BENEFITS

ORIGINAL EJECTX

- No tipping
- Reduced operating costs and cycle times
- Heavy-duty, full Bisalloy body
- Safer near powerlines, low hanging trees and obstructions
- Reduced roll over risk
- Reduced "carry-back" due to specifically designed scrapers on the plough
- Greater operating range with the ability to eject on adverse slopes
- Able to eject sticky and cold asphalt
- Suitable for all applications
- No restriction of material type*
- Easy to operate
- No belts, chains, slats, bearings or hydraulic motors (causing costly repairs)
- Low centre of gravity
- Low side height – for loading with bobcat
- Allowed on all job sites in Australia

ASPHALT EJECTX

- No tipping
- Reduced operating costs and cycle times
- Heavy-duty, full Bisalloy body
- Safer near powerlines, low hanging trees and obstructions
- Reduced roll over risk
- Reduced "carry-back" due to specifically designed scrapers on the plough
- Greater operating range with the ability to eject on adverse slopes
- Able to eject sticky and cold asphalt
- Easy to operate
- No belts, chains, slats, bearings or hydraulic motors (causing costly repairs)
- Low centre of gravity
- Low side height – for loading with bobcat
- Allowed on all job sites in Australia

* EjectX is capable of carting any material including rock, concrete, demolition materials, crusher dust and asphalt – hot or cold.



ORIGINAL EJECTX

- 1 Head board
- 2 Flashing lights
- 3 Steel tarp cover
- 4 Hydraulic tank
- 5 Hydraulic valve
- 6 Water tank
- 7 Toolbox
- 8 Ram mount
- 9 Multistage plough
- 10 Plough rollers
- 11 Plough scrapers
- 12 Plough scraper retainers
- 13 Plough
- 14 Roller guide
- 15 Cameras
- 16 Side work lights
- 17 Pull out ladder
- 18 Side stiffeners
- 19 Crash box
- 20 Rear tailgate lift rams
- 21 Rear tailgate hinge
- 22 Rear tailgate
- 23 Secondary rear tailgate locks
- 24 Air actuated fold-up tail lights & mud flaps

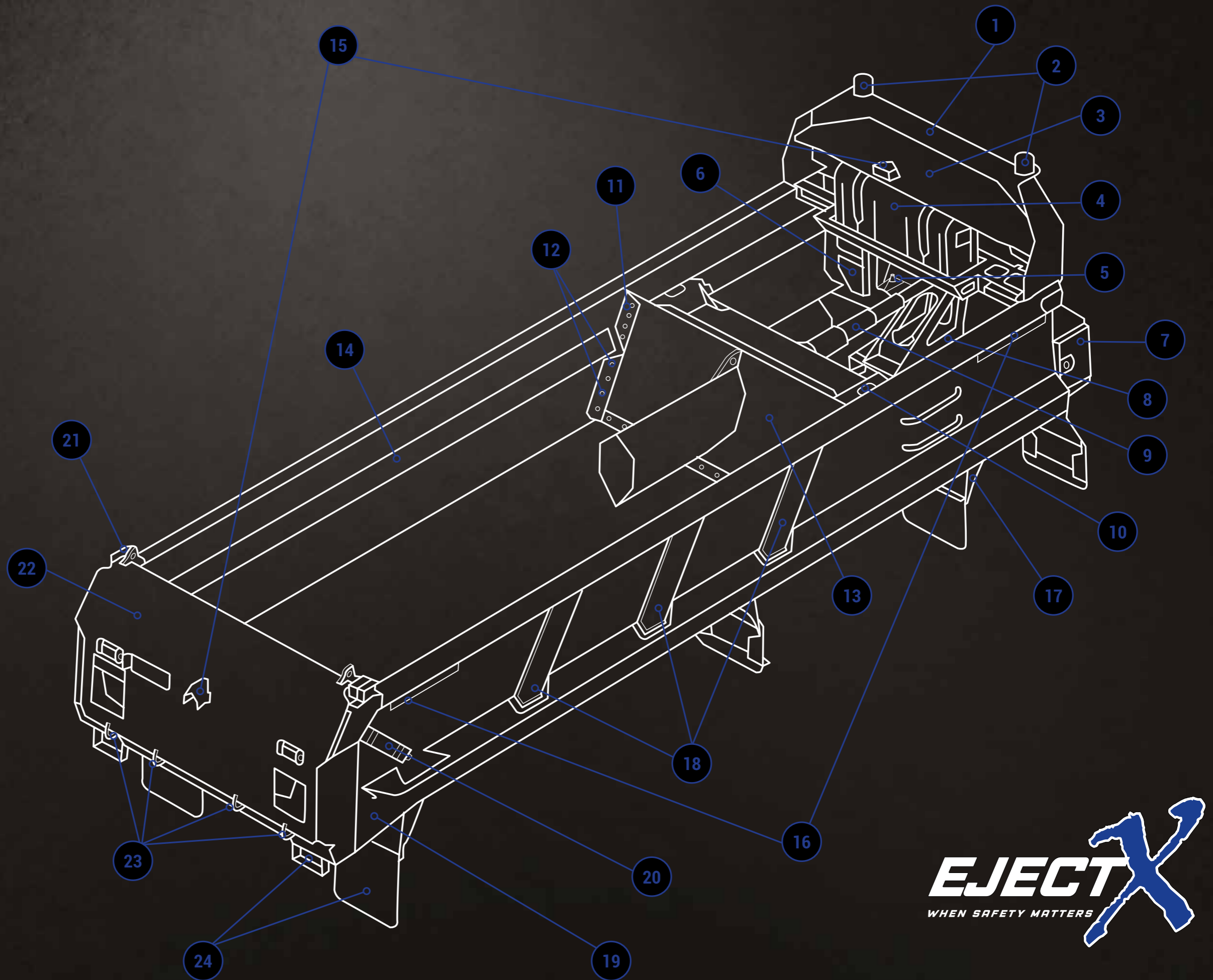

ASPHALT EJECTX

- 1 Bolt-on headboard
- 2 Tarp cover
- 3 Bolt-in ram mount
- 4 Side Stiffeners
- 5 Ram cover
- 6 Tail lights
- 7 Tailgate locks
- 8 Rear chute
- 9 Air actuated tailgate
- 10 Plough rails
- 11 Body stiffening bars
- 12 Plough scraper
- 13 Plough

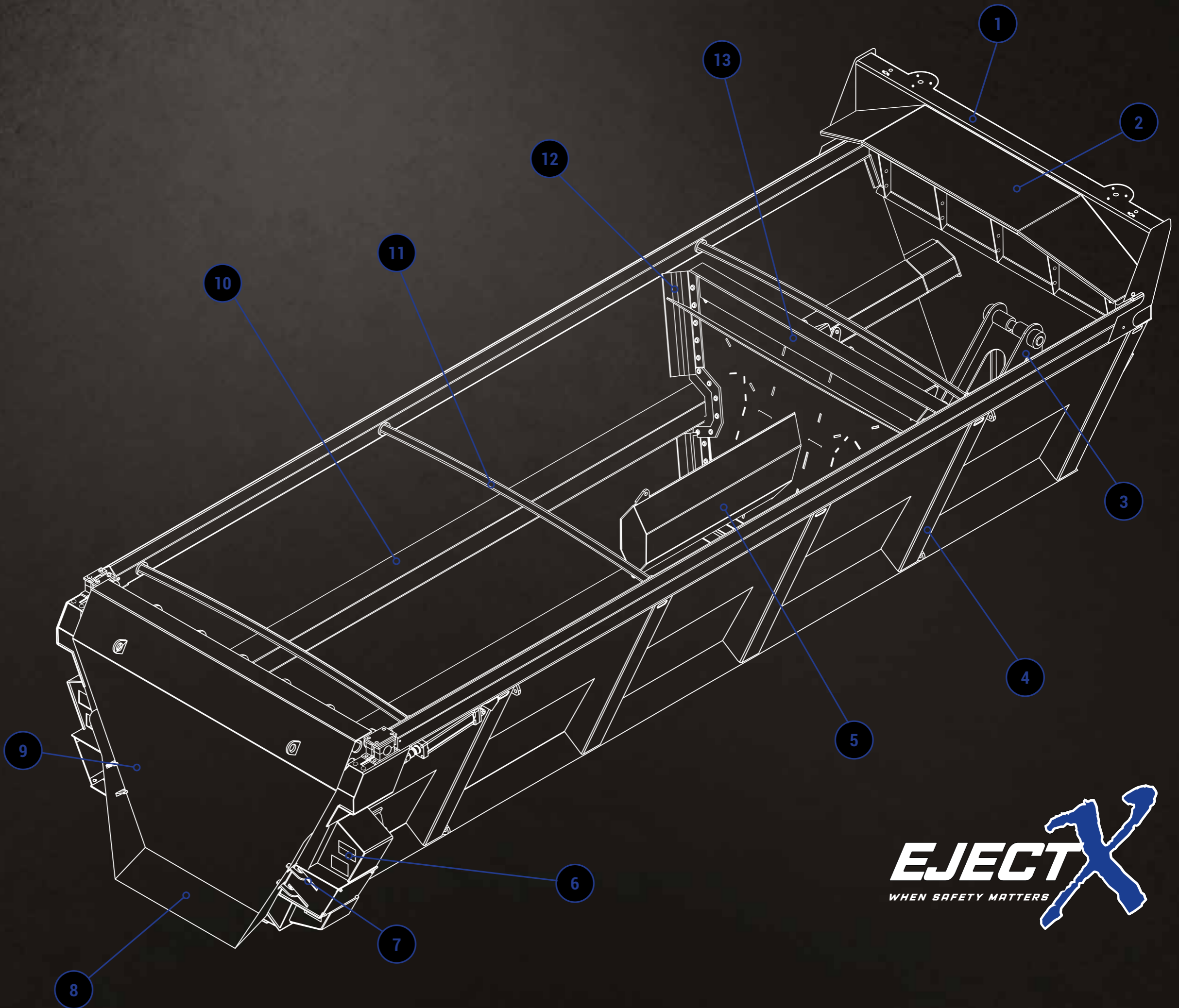

DIFFERENCES

ORIGINAL EJECTX

- Designed to cater for general contracting use, including asphalt.
- Rectangular shaped body to allow versatility.

ASPHALT EJECTX

- Designed specifically for free flowing material such as asphalt, sand, gravels, road profiling's and DGB.
- V shaped body with a narrow, rear chute designed specifically for unloading into pavers.
- Light weight body. As everyone knows, the lighter the body, the higher the payload.
- New design plough system with easy adjustment.
- Lower centre of gravity.



FREQUENTLY ASKED QUESTIONS

ORIGINAL EJECTX

- **What material can it carry?**
You can put any material in the back including rock, fill demolition material, concrete and asphalt, hot or cold.
- **What size does it come in?**
4.7m, 5.1m, 6m, 6.4m, 7.2, 7.6m
(can do custom size at additional cost)
- **Can my tail lights and tailgate get damaged when unloading?**
No. The tailgate lifts up and is out of the way prior to unloading. The tail lights also retract and fold up well out of the way when the tailgate dogs unlock.
- **Tare weight?**
7.6m long body (most popular size), approximately 4.3 tonnes. Includes ram and hydraulic oil.
- **Cubic capacity?**
7.6m long body = approximately 14.35 cubic metres
- **Maintenance required?**
The maintenance required is the scraper around the plough – this is a consumable part, averaging around 6–12 months depending on the conditions; and periodic plough roller adjustments (no cost involved). Otherwise, there is very little maintenance involved.
- **Maintenance costs?**
6–12 months scraper replacement.
- **Can I put one on my existing truck?**
Yes you can. These bodies can be tailor made to suit your needs or your truck.

ASPHALT EJECTX

- **What material can it carry?**
Free flowing material such as asphalt, sand, gravels, road profilings and DGB.
- **What size does it come in?**
4.7m, 5.1m, 6m, 6.4m, 7.2, 7.6m
(can do custom size at additional cost)
- **Can my tail lights and tailgate get damaged when unloading?**
No. The tailgate lifts up and is out of the way prior to unloading. The tail lights also retract and fold up well out of the way when the tailgate dogs unlock.
- **Tare weight?**
6.4m long body; approximately 2.7 tonnes. Includes ram and hydraulic oil.
- **Cubic capacity?**
6.4m asphalt body = approximately 11 cubic metres.
- **Maintenance required?**
The maintenance required is the scraper around the plough – this is a consumable part, averaging around 6–12 months depending on the conditions; and periodic plough roller adjustments (no cost involved). Otherwise, there is very little maintenance involved.
- **Maintenance costs?**
6–12 months scraper replacement.
- **Is cleaning required?**
Yes. When cleaning is required, like all bodies, the plough is easily accessible as it protrudes through the rear of the body.

ORIGINAL EJECTX

- **Can my standard tipper body be converted to your ejection system?**
No it can not. Our bodies are built from the ground up and are a fully engineered design with gussets and stiffeners in the correct position to take the forces applied
- **Does it tip?**
No. The EjectX always stays in a fixed and stable position, which reduces driver error and puts the material exactly where you need it, without any risk of powerlines, overhanging tree limbs, signage and uneven ground—all the things that are a part of working with tip trucks.
- **Why an Ejector over a walking floor / live bottom?**
See benefits on the following page.

ASPHALT EJECTX

- **Can it only cart asphalt?**
It can cart asphalt and all free flowing materials.
- **Why an Ejector over a walking floor / live bottom?**
See benefits on the following page.



BENEFITS OVER LIVE BOTTOM TRAILER

ORIGINAL EJECTX

- Low repairs and maintenance costs.
- Lower sides – use for clean up.
- Can eject cold and sticky asphalt, along with large rock and demolition debris.
- Less obtrusive parts to be hit and damaged.
- Can eject anything.
- Less moving parts and a less complex system = less to go wrong.
- No belts, slats, chains or bearings.
- Lower centre of gravity.
- Clean body after ejecting load.
- Controlled material displacement.

ASPHALT EJECTX

- Low repairs and maintenance costs.
- Lower sides – use for clean up.
- Can eject cold and sticky asphalt.
- Less obtrusive parts to be hit and damaged (e.g hydraulic motors and hoses).
- 10% lighter than nearest live bottom competitor.
- Less moving parts and a less complex system = less to go wrong.
- No belts, slats, chains or bearings.
- Lower centre of gravity.
- Clean body after ejecting load.
- Controlled material displacement.

FEATURES

ORIGINAL EJECTX

- Reverse cameras x 2:
One camera to look over the load and another camera to look behind the vehicle.
** Note: Depending on vehicle brand.*
- Retractable tarp (manual or electric).
- Steel tarp cover.
- Remote control.
- Air actuated folding tail lights and mud flaps.
- Tool box.
- Rear work lights x 2
- Flashing lights x 2
- Shovel/scrapper holder.
- Water tank with soap dispenser.
- Reverse alarm.
- Crash boxes.

ASPHALT EJECTX

- Reverse cameras x 2:
One camera to look over the load and another camera to look behind the vehicle.
** Note: Depending on vehicle brand.*
- Retractable tarp (manual or electric).
- Steel tarp cover.
- Rear chute.
- Remote control.
- Air actuated folding tail lights and mud flaps.
- Removeable mudflaps.
- Tool box.
- Rear work lights x.2
- Flashing lights x 2
- Side work lightbars x 4
- Shovel / scraper holder.
- Water tank with soap dispenser.
- Reverse alarm.

MAINTENANCE COST COMPARISON*

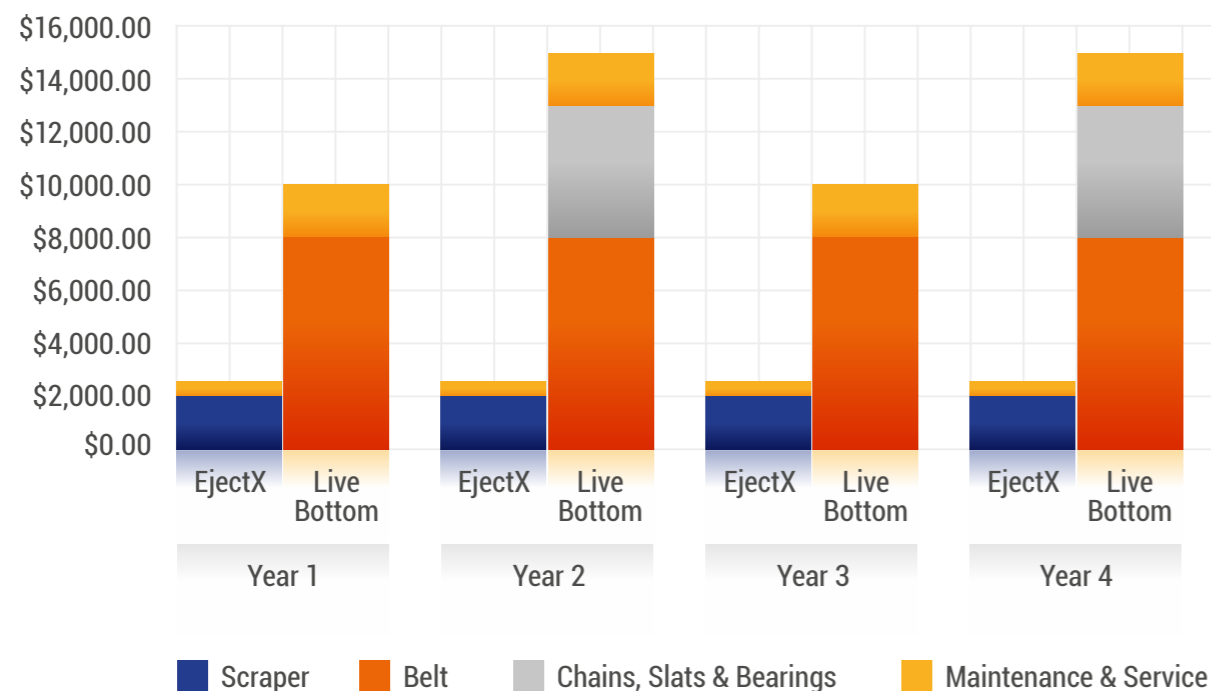

*Values are an estimate only based on information provided by owners of both types of bodies.





ShawX is proudly Australian owned.
Earthmoving innovation at its finest.
Built strong for all conditions.



(07) 3286 3794

info@shawx.com.au

ejectx.com.au

